

Applications:

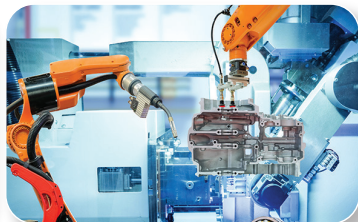

Industrial Robotics



Factory Automation



Medical Equipment



Plug-In



Floating

Discover Hirose's newest addition – the HR34P Series.

Meet the HR34P Series by Hirose Electric: Your compact, reliable blind mate connectivity solution. Engineered for easy assembly, it features a precision floating design for seamless mating. Perfect for high-precision and durability needs, the HR34P ensures secure connections across demanding applications.

HIGHLIGHTS:

Small Blind Mate Connector

- Blind mate connection for efficient assembly
- Floating design allows easy mating
Floating Amount: $\pm 0.5\text{mm}$ in X and Y directions
- Keyed housing prevents incorrect mating



Floating Design

Floating screws enable floating mating of $\pm 0.5\text{mm}$ in X and Y directions.

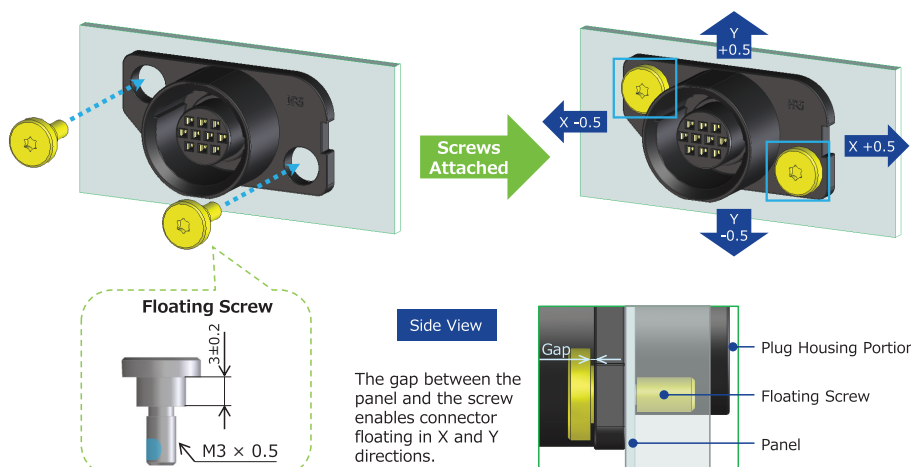

Floating Design Allows Easy Blind Mate Connection

CLICK HERE
FOR MORE INFORMATION

CLICK HERE TO ORDER
SAMPLE NUMBER:
US-HR34PSAMPLE-24

Rack to Panel Connection

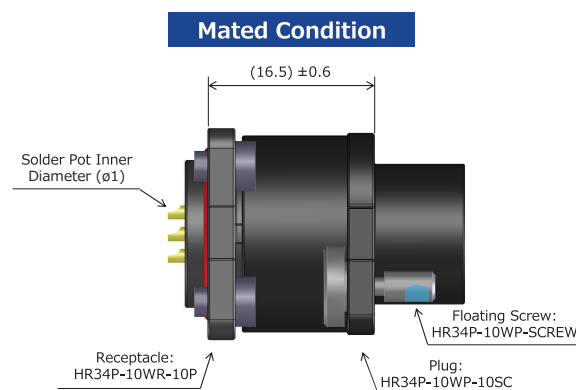

Z Direction (Mating Axis):
 $\pm 0.6\text{mm}$ Misalignment Absorbed

Reliable Design

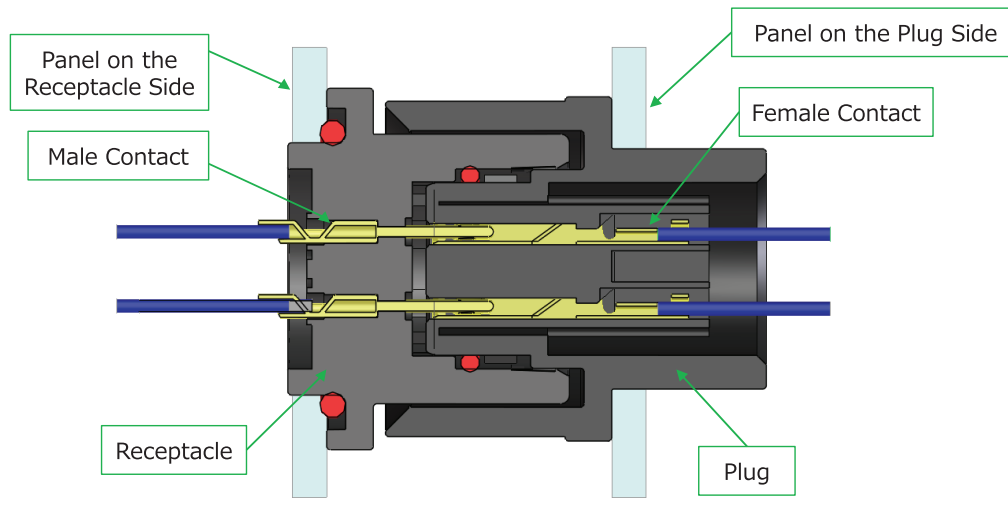

O-RING

O-rings located at each connection point prevent water from entering the connector.

Specifications

Material and Finish

COMPONENT		MATERIAL	FINISH, REMARKS
Receptacle	Insulator	Polyamide Resin	UL94V-0, Black
	Male Contact	Copper Alloy	(Contact Area) Gold Plated (Terminal Area) Gold Plated (Under Plating) Nickel
	O-ring	Silicone Rubber	Red
Plug	Insulator	Polyamide Resin	UL94V-0, Black
Female Contact		Phosphor Bronze	(Contact Area) Gold Plated (Terminal Area) Nickel Plated (Under Plating) Nickel
Floating Screw		Stainless Steel	Silver (Nylok: Blue)

Performance Characteristics

Rated Current	3A
Rated Voltage	200V AC, 250V DC
Operating Temperature	-40 to +105°C*
Contact Resistance	20mΩ Max. (1A DC)
Withstanding Voltage	900V AC for 1 min.
Insulation Resistance	1000MΩ Min. (500V DC)
Mating Durability	30 times

- Applicable Cables : 20-25 AWG
- RoHS Compliant

* Includes the temperature rise by current flow



For additional information please go to
www.hirose.com/product/series/HR34P

Specifications herein are subject to change without notice.
 Contact Hirose for latest specifications, drawings, or availabilities.

STAY CONNECTED

